

Flat (EPC Rating: D)

**12 THE RETREAT, GRAYS, ESSEX, RM17 6QU**

Per Month

**£1,600 Per**



moovinhom.co.uk



2



1



null



D

# 2 Bedroom Flat located in Essex

Moovinhome are pleased to present this bright, spacious and well-maintained two-bedroom apartment situated within the quiet residential development of The Retreat, Grays, RM17 6QU.

This modern apartment offers well-balanced accommodation throughout and is ideally positioned just a short walk from Grays Station and Grays High Street, providing excellent transport connections into London alongside convenient access to local shops, supermarkets, restaurants, schools and everyday amenities.

The property comprises two generously sized bedrooms, a bright and airy reception room, a modern fitted kitchen, and a contemporary bathroom suite. Further benefits include allocated parking, ample natural light throughout, double glazing and a peaceful cul-de-sac location.

The apartment is well suited to professional tenants, couples and small families seeking a well-connected home within a convenient yet quiet residential setting.

Viewings are highly recommended.



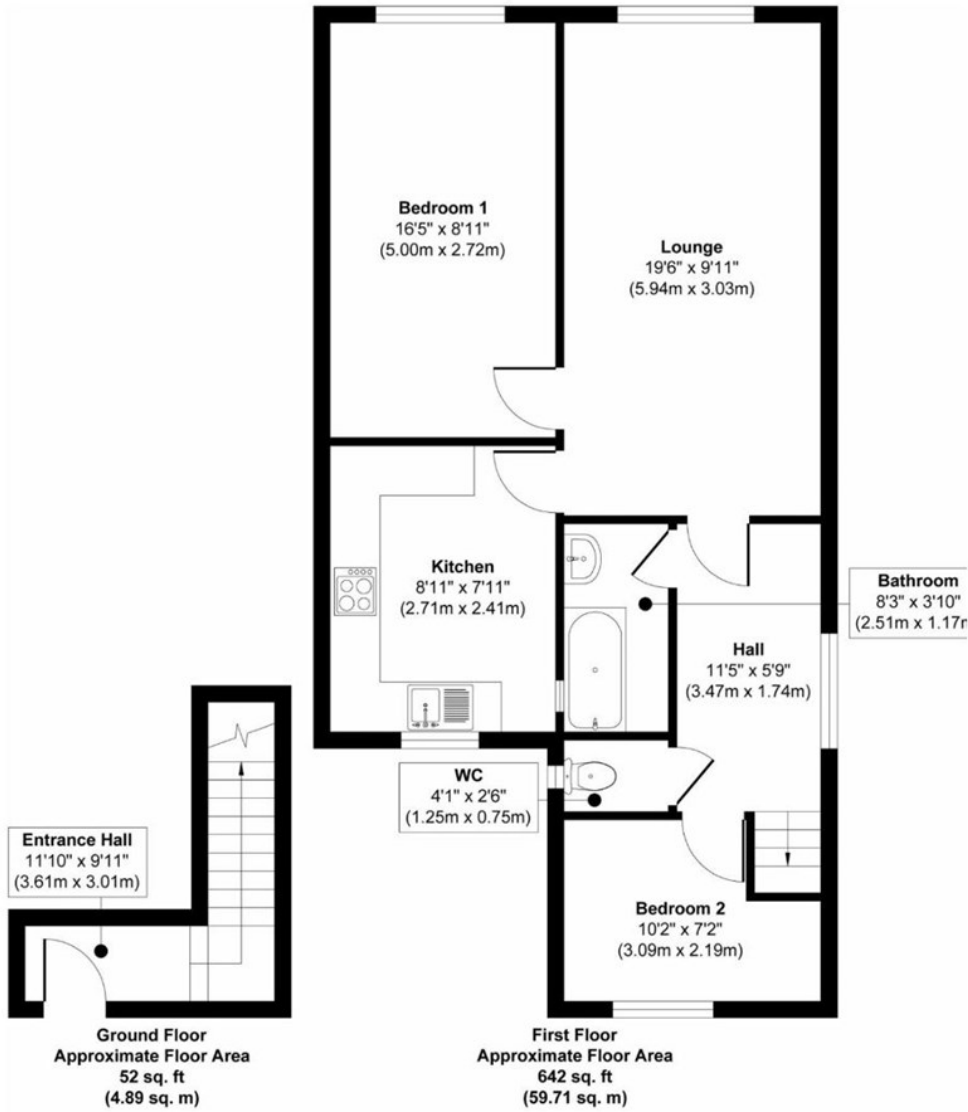

**Approx. Gross Internal Floor Area 694 sq. ft / 64.60 sq. m**

Whilst every attempt has been made to ensure the accuracy of the floor plan contained here, measurements of doors, windows, rooms and any other items are approximate and no responsibility is taken for any error, omission, or mis-statement. The measurements should not be relied upon for valuation, transaction and/or funding purposes. This plan is for illustrative purposes only and should be used as such by any prospective purchaser or tenant.

Council Tax Band

**A**

Energy Performance Graph

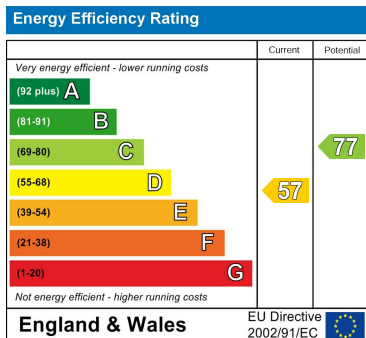

Call us on

**0208 175 3999**

[info@moovinhom.co.uk](mailto:info@moovinhom.co.uk)

[moovinhom.co.uk](http://moovinhom.co.uk)

Agents Note: Whilst every care has been taken to prepare these particulars, they are for guidance purposes only. All measurements are approximate and are for general guidance purposes only and whilst every care has been taken to ensure their accuracy, they should not be relied upon and potential buyers are advised to recheck the measurements.